

DOWNTOWN PHOENIX ENHANCED MUNICIPAL SERVICES DISTRICT 2024 ASSESSMENT DIAGRAM

SUBMITTED _____ DATE _____
 SUPERINTENDENT OF STREETS
 APPROVED AT THE MEETING OF THE COUNCIL OF THE CITY OF PHOENIX THIS _____ DAY OF _____, 2023
 MAYOR
 ATTEST _____
 CITY CLERK
 FILED THIS _____ DAY OF _____, 2023
 SUPERINTENDENT OF STREETS

LEGEND & SCALE

- 1 ASSESSMENT #
- STREETSCAPE IMPROVEMENT DISTRICT

0 125 250 375 500 Feet
 1 INCH = 125 FEET

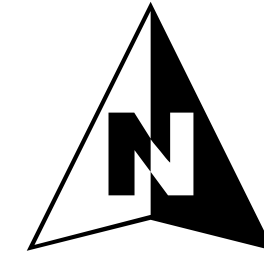

This drawing was created for reference and planning purposes only and not for construction.

Parcel data from County Assessor as of 4/6/2023.
 Assessment data updated as of 9/19/2023.

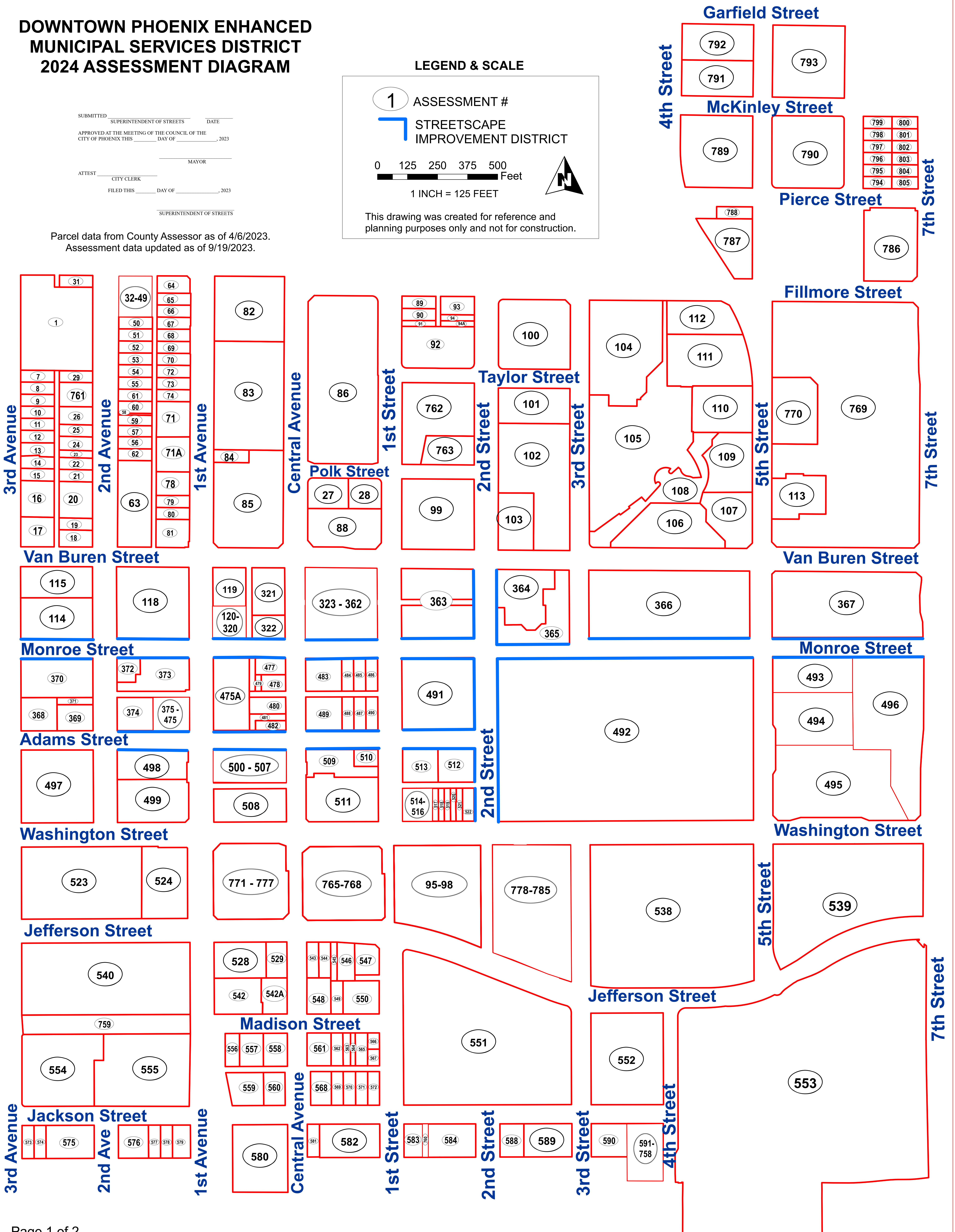

DOWNTOWN PHOENIX ENHANCED MUNICIPAL SERVICES DISTRICT 2024 ASSESSMENT DIAGRAM DETAIL

ID #	Owner	Lot Size in Square Feet	County Parcel #	Building Size in Square Feet	ID #	Owner	Lot Size in Square Feet	County Parcel #	Building Size in Square Feet	ID #	Owner	Lot Size in Square Feet	County Parcel #	Building Size in Square Feet
1	FILMORE APARTMENTS OWNER LLC	97,222	111-42-139	292,582	202	44 MONROE APARTMENTS LLC	1,126	112-21-459	1,126	405	MINDLE AARON LAWRENCE	837	112-21-313	837
2	Parcel No Longer Exists - Merged into ID 1				203	44 MONROE APARTMENTS LLC	1,194	112-21-460	1,194	406	SWINDELE TIMOTHY D/KERRY K	837	112-21-314	837
3	Parcel No Longer Exists - Merged into ID 1				204	44 MONROE APARTMENTS LLC	1,394	112-21-461	1,394	407	THORPE DAVIN M	858	112-21-315	858
4	Parcel No Longer Exists - Merged into ID 1				205	44 MONROE APARTMENTS LLC	1,126	112-21-462	1,126	408	STEVE TODD/EMER	755	112-21-316	755
5	Parcel No Longer Exists - Merged into ID 1				206	44 MONROE APARTMENTS LLC	962	112-21-463	962	409	HILAN SUSAN	910	112-21-317	910
6	Parcel No Longer Exists - Merged into ID 1				207	44 MONROE APARTMENTS LLC	1,130	112-21-464	1,130	410	AFRICA EDWIN S II	1,254	112-21-318	1,200
7	JOHN E GARRETTSON LIVING TRUST/GARRETTSON JOHN	7,000	111-42-026	Parking Lot	411	COX RICHARD	1,159	112-21-465	1,159	411	STEER THEODORE	1,288	112-21-320	1,174
8	JOHN E GARRETTSON LIVING TRUST/GARRETTSON JOHN	7,000	111-42-024	Parking Lot	209	44 MONROE APARTMENTS LLC	1,323	112-21-466	1,323	412	RUBIN BRETT	1,148	112-21-321	1,098
9	333 N. 3RD AVE LLC	7,000	111-42-022	Parking Lot	210	44 MONROE APARTMENTS LLC	1,126	112-21-467	993	413	ALL STATE HOMES LLC	1,422	112-21-322	1,295
10	333 N. 3RD AVE LLC	7,000	111-42-020	Parking Lot	211	44 MONROE APARTMENTS LLC	1,326	112-21-468	1,326	414	MILLER JEFFREY A	837	112-21-323	837
11	333 N. 3RD AVE LLC	7,000	111-42-019	Parking Lot	212	44 MONROE APARTMENTS LLC	1,394	112-21-469	1,394	415	DILLAVOU CHRISTINA/BEREMAN NANCY	837	112-21-324	837
12	333 N. 3RD AVE LLC	7,000	111-42-017	Parking Lot	213	44 MONROE APARTMENTS LLC	1,126	112-21-470	1,126	416	METCALF BRIAN	866	112-21-325	858
13	333 N. 3RD AVE LLC	8,138	111-42-015	Vacant Lot	214	44 MONROE APARTMENTS LLC	962	112-21-472	962	418	MACKIN SARAH	755	112-21-326	755
14	333 N. 3RD AVE LLC	7,000	111-42-013A	Vacant Lot	215	44 MONROE APARTMENTS LLC	1,310	112-21-473	1,310	419	BROWES JACK A	755	112-21-327	710
15	333 N. 3RD AVE LLC	7,000	111-42-009	Vacant Lot	216	44 MONROE APARTMENTS LLC	1,126	112-21-474	1,126	420	GRIFFIN DARINE	861	112-21-328	861
16	ZAVO GROUP LLC	21,000	111-42-115	10,864	217	44 MONROE APARTMENTS LLC	1,139	112-21-475	1,139	421	GINA SANTI LIVING TRUST	1,098	112-21-330	1,098
17	JOHN E GARRETTSON LIVING TRUST/ETAL	17,478	111-42-005A	Parking Lot	218	44 MONROE APARTMENTS LLC	1,126	112-21-476	993	422	NORMA JEAN CLIFTON SURVIVORS TRUST	1,288	112-21-331	1,288
18	HIGSONBOTHAM PROPERTIES LLC	11,200	111-42-003	12,856	219	44 MONROE APARTMENTS LLC	1,126	112-21-477	1,126	423	PORTER RUSSEL BENJON	1,098	112-21-332	1,098
19	HIGSON PROPERTIES LLC	7,000	111-42-006	6,999	220	44 MONROE APARTMENTS LLC	1,394	112-21-478	1,394	424	DAVIS JUSTIN ROBERT/BETTY ANN HINDERS TR	837	112-21-332	837
20	FEI - GSA Parking Lot	21,000	111-42-007B	Parking Lot	221	44 MONROE APARTMENTS LLC	1,126	112-21-479	1,126	425	VANCE KRISTIN	837	112-21-333	837
21	CUNNINGHAM BUILDINGS LLC	7,000	111-42-008	See ID # 22	222	44 MONROE APARTMENTS LLC	1,126	112-21-480	1,126	426	MORALES GABRIEL	866	112-21-334	837
22	CUNNINGHAM BUILDING LLC	7,000	111-42-010	10,955	223	44 MONROE APARTMENTS LLC	962	112-21-481	962	427	SUMAR INVESTMENTS DOWNTOWN LLC	866	112-21-335	858
23	GARRETTSON JOHN E & BARTON L FABER	4,200	111-42-012	Parking Lot	224	44 MONROE APARTMENTS LLC	1,310	112-21-482	1,310	428	MELTON MICHELLE	796	112-21-336	796
24	GARRETTSON JOHN E & BARTON L FABER	8,400	111-42-013	Parking Lot	225	44 MONROE APARTMENTS LLC	1,159	112-21-483	1,159	429	ALL STATE HOMES LLC	1,422	112-21-339	1,219
25	GARRETTSON JOHN E & BARTON L FABER	7,000	111-42-016	Parking Lot	226	44 MONROE APARTMENTS LLC	1,323	112-21-484	1,323	430	SIMMONS EARL/JONISSON AMY	960	112-21-338	961
26	JOHN E GARRETTSON LIVING TRUST/GARRETTSON JOHN	10,500	111-42-018	Parking Lot	227	44 MONROE APARTMENTS LLC	993	112-21-485	993	431	LE KRISTIE/SUMNER	960	112-21-339	853
27	AP 355 N CENTRAL PROPERTY LLC /C/O RAJEN SHASTRI	21,675	111-45-188B	333,508	228	44 MONROE APARTMENTS LLC	1,126	112-21-486	1,126	432	LEIBERTER GROUP LLC	45,389	112-21-340	2,769
28	APPEL TREE HOUSING COMMUNITY OWNERSHIP INC.	115,271	111-45-189	1,257,871	229	44 MONROE APARTMENTS LLC	1,394	112-21-487	1,394	433	HOWARD PAUL	1,098	112-21-341	1,098
29	BURKE GOLDIE H & RICHARD W	7,000	111-42-025	3,508	230	44 MONROE APARTMENTS LLC	1,126	112-21-488	1,126	434	RESSEGUIE WILLIAM T	833	112-21-342	833
30	LYON SWINDELE PATRICIA E	7,000	111-42-024A	Parking Lot	231	44 MONROE APARTMENTS LLC	1,126	112-21-489	1,126	435	WATSON JENNIFER ANNE	866	112-21-343	866
31	SCHIEF ABIGAIL A	1,000	111-42-117	984	232	44 MONROE APARTMENTS LLC	1,126	112-21-490	1,126	436	BEUL BRENDAN MICHAEL/MICHAEL S/MELANE R	866	112-21-344	866
32	FERGUSON ANNE YVONNE	1,100	111-42-118	1,100	233	44 MONROE APARTMENTS LLC	1,159	112-21-492	1,159	437	VILA GUYO	796	112-21-346	796
33	MYERS JOHN	1,358	111-42-119	1,358	234	44 MONROE APARTMENTS LLC	1,159	112-21-493	1,159	438	ORPHEUM GROUP LLC	796	112-21-346	796
34	MELISSA S CARLITH LIVING TRUST	1,243	111-42-120	1,243	235	44 MONROE APARTMENTS LLC	993	112-21-493	993	439	MARICOPA COUNTY	1,126	112-21-347	1,126
35	DODGE MARIA	960	111-42-121	960	236	44 MONROE APARTMENTS LLC	1,126	112-21-494	1,126	440	WESTERMAN ROBERT	797	112-21-348	797
36	VARELA SEAN CLAYTON/JORJUE MADALENA	927	111-42-122	927	238	44 MONROE APARTMENTS LLC	1,126	112-21-495	1,126	441	ORPHEUM 807 LLC	960	112-21-349	960
37	SCOTT THODORIS	1,310	111-42-123	1,310	239	44 MONROE APARTMENTS LLC	1,394	112-21-496	1,394	442	GUYER KATHLEEN LIVING TRUST	1,126	112-21-350	1,126
38	COSKY EMILY DIANE/DAVENPORT MARY R	1,310	111-42-124	937	240	44 MONROE APARTMENTS LLC	1,394	112-21-497	1,394	443	MARY MCDONOUGH LIVING TRUST	1,162	112-21-351	1,098
39	SHERMAN JEFFREY	1,334	111-42-125	1,334	241	44 MONROE APARTMENTS LLC	1,126	112-21-498	1,126	444	GEISER JULIAN	833	112-21-352	833
40	NORTHWOOD LLC	1,247	111-42-126	1,247	242	44 MONROE APARTMENTS LLC	962	112-21-499	962	445	PHAM GROUP LLC	793	112-21-353	837
41	MARCO MICHELLE ANN	1,492	111-42-127	1,492	243	44 MONROE APARTMENTS LLC	1,126	112-21-500	1,126	446	TRANK MARY FERRE	842	112-21-354	842
42	CORENS KIMBERLY J/PALU F	1,338	111-42-128	1,338	244	44 MONROE APARTMENTS LLC	1,880	112-21-503	1,880	447	SMITH JAMES	866	112-21-355	858
43	HAMMERSMITH TRUST	1,239	111-42-129	1,239	245	44 MONROE APARTMENTS LLC	1,873	112-21-504	1,873	448	ARMENITA BENNEMARLA	797	112-21-356	797
44	MURPHY EMILY	1,239	111-42-130	1,239	246	44 MONROE APARTMENTS LLC	1,126	112-21-505	1,126	449	QUIN JAMES/MARGA	866	112-21-357	866
45	PETERSON ANDREW	1,094	111-42-131	1,094	247	44 MONROE APARTMENTS LLC	1,394	112-21-506	1,394	450	JOVELLANOS ROEL	797	112-21-358	861
46	EXTENSION FAMILY TRUST	1,883	111-42-132	1,883	248	44 MONROE APARTMENTS LLC	1,394	112-21-507	1,394	451	SHEED SCOTT	960	112-21-359	960
47	REI MANAGEMENT LLC	1,270	111-42-133	1,270	249	44 MONROE APARTMENTS LLC	1,126	112-21-508	1,126	452	SIAMMANG HANH TRU	1,289	112-21-360	1,274
48	ADELMAN JENNIFER KATE/GUTIERREZ RICK JOSEPH	7,000	111-42-134	1,340	250	44 MONROE APARTMENTS LLC	1,126	112-21-509	1,126	453	CASCARD SANDOVAL FAMILY LIVING	417	112-21-361	1,098
49	533 2ND AVE LLC	7,000	111-42-080	Parking Lot	251	44 MONROE APARTMENTS LLC	1,880	112-21-510	1,880	454	BOUCHEE SHEREE	833	112-21-362	833
50	533 2ND AVE LLC	7,000	111-42-080	Parking Lot	252	44 MONROE APARTMENTS LLC	1,873	112-21-509	1,873	455	HLK MANAGEMENT LLC	794	112-21-363	837
51	533 2ND AVE LLC	7,000	111-42-080	Parking Lot	253	44 MONROE APARTMENTS LLC	1,126	112-21-511	1,126	456	MONROE BRANDON	866	112-21-364	866
52	533 2ND AVE LLC	7,000	111-42-076	Parking Lot	254	44 MONROE APARTMENTS LLC	1,126	112-21-511	1,126	457	DOBNEY ROBERT MARC	866	112-21-365	858
53	533 2ND AVE LLC	7,000	111-42-074	Parking Lot	255	44 MONROE APARTMENTS LLC	1,394	112-21-512	1,394	458	HE & COMPANY LLC	796	112-21-366	751
54	533 2ND AVE LLC	7,000	111-42-067	Parking Lot	256	44 MONROE APARTMENTS LLC	1,126	112-21-514	1,126	459	FRANK MARGARET/LEWIS MARGOT HAHN	866	112-21-367	866
55	533 2ND AVE LLC	7,000	111-42-065	Parking Lot	257	44 MONROE APARTMENTS LLC	1,126	112-21-515	1,126	460	MERTENS SCOTT E	866	112-21-368	861
56	533 2ND AVE LLC	7,000	111-42-066	Parking Lot	258	44 MONROE APARTMENTS LLC	1,880	112-21-515	1,880	461	WALSH MATTHEW R	960	112-21-369	960
57	533 2ND AVE LLC	7,000	111-42-067	Parking Lot	259	44 MONROE APARTMENTS LLC	1,880	112-21-540	1,880	462	SMAN MARCO T J LLC	1,289	112-21-370	1,174
58	533 2ND AVE LLC	7,000	111-42-067	Parking Lot	260	44 MONROE APARTMENTS LLC	1,126	112-21-541	1,126	463	FRANZ MARY MARIE	866	112-21-371	1,098
59	533 2ND AVE LLC	7,000	111-42-069	Parking Lot	261	44 MONROE APARTMENTS LLC	993	112-21-542	993	464	SIGALA ERIC ALBERTO	797	112-21-372	833
60	533 2ND AVE LLC	7,000	111-42-071	Parking Lot	262	44 MONROE APARTMENTS LLC	1,126	112-21-543	1,126	465	HANS W MATHERS TRUST	2,559	112-21-373	2,688
61	533 2ND AVE LLC	7,000	111-42-072	Parking Lot	263	44 MONROE APARTMENTS LLC	1,126	112-21-543	1,126	466	HANS W MATHERS TRUST	2,559	112-21-373	2,688
62	533 2ND AVE LLC	7,000	111-42-073	Parking Lot	264	44 MONROE APARTMENTS LLC	1,126	112-21-543	1,126	467	HANA GROUP LLC	1,487	112-21-375	9,445
63	PHOENIX - Wells Fargo Building	52,990	111-42-106B	253,464	265	44 MONROE APARTMENTS LLC	1,140	112-21-545	1,140	468	PC RESTAURANT GROUP LLC	1,568	112-21-384	9,445
64	ASU Downtown Residence Hall	9,499	111-42-087A	1,114	266	44 MONROE APARTMENTS LLC	1,126	112-21-546	1,126	469	ADAMS ADAM G	3,208	112-21-385	9,445
65	ASU Downtown Residence Hall	7,000	111-42-088	3,010	267	44 MONROE APARTMENTS LLC	1,126	112-21-548	1,126	470	HEM PHAMMINH LLC	1,416	112-21-387	9,445
66	ASU Downtown Residence Hall	7,000	111-42-089	1,803	268	44 MONROE APARTMENTS LLC	1,873	112-21-549	1,873	471	DAIS			